

-SHOWN OPEN WITH PLUG UP
-RECOMMENDED ORIENTATION
FOR BURIED SERVICE

DETAIL A
SCALE 1 : 1

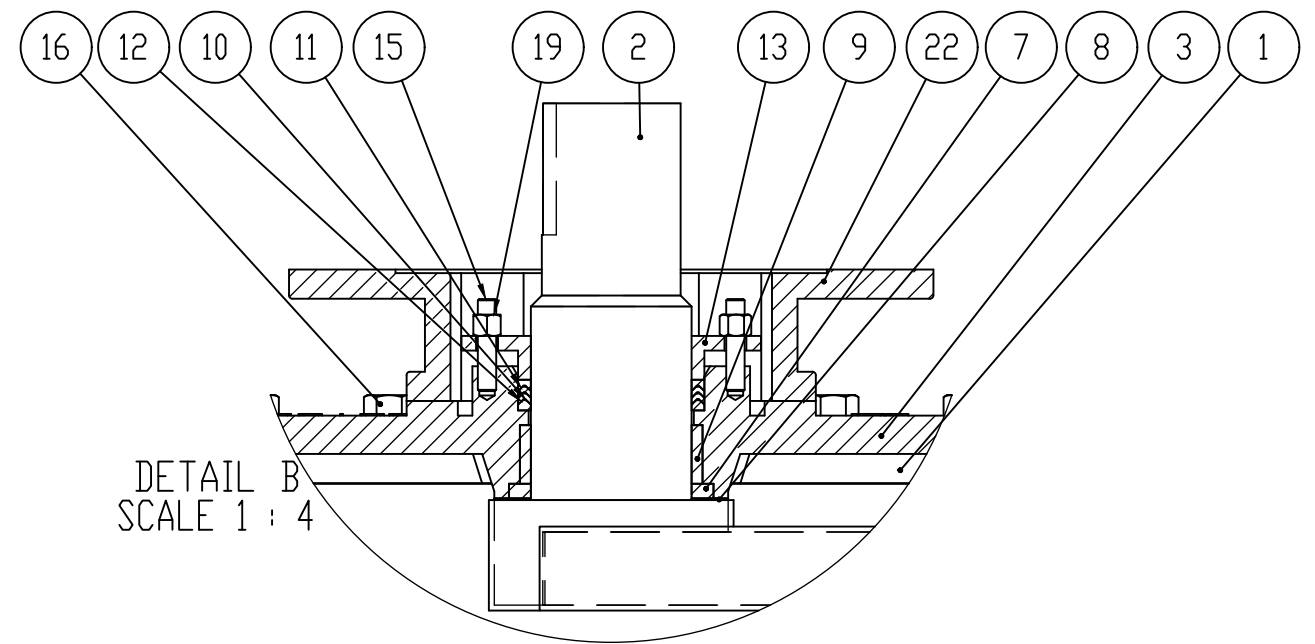

DETAIL B
SCALE 1 : 4

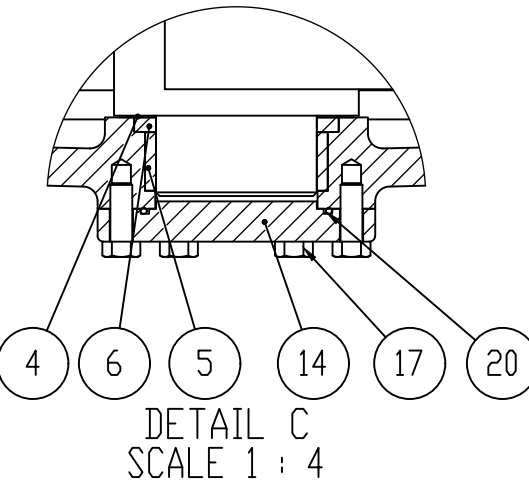

DETAIL C
SCALE 1 : 4

ITEM NO.	PART NUMBER	DESCRIPTION
1	Body-MJ	ASTM A536 Gr. 65-45-12 or 70-50-05
2	Plug I Rubber Coating	ASTM A536 Gr. 65-45-12 or 70-50-05 I NBR
3	Cover	ASTM A536 Gr. 65-45-12 or 70-50-05
4	Bottom Thrust	PTFE
5	Bottom Bearing	Sintered Alloy SS316
6	Grit Guard Shaft Seal (Lower)	NBR
7	Grit Guard Shaft Seal (Upper)	NBR
8	Upper Thrust	PTFE
9	Upper Bearing	Sintered Alloy SS316
10	V2-Packing-AN6225-55	NBR
11	V2-Top-Packing-AN6225-55	NBR
12	V-Bottom-Packing-AN6225-55	NBR
13	FP Gland (for Actuator)	ASTM A536 Gr. 65-45-12 or 70-50-05
14	Bottom Cover	ASTM A536 Gr. 65-45-12 or 70-50-05
15	Cover Studs	Stainless Steel ASTM A276.T316
16	Hexagon Cover Bolts	Stainless Steel ASTM A276.T316
17	Bottom Cover Bolts	Stainless Steel ASTM A276.T316
18	Hexagon Adaptor Bolts	Stainless Steel ASTM A276.T316
19	Cover Stud Hex Nut	Stainless Steel ASTM A276.T316
20	O-ring Bottom Cover	NBR
21	O-Ring Top Cover	NBR
22	FP Adaptor-Close	ASTM A536 Gr. 65-45-12 or 70-50-05
957	Gear Bolts	Stainless Steel ASTM A276 T316

- NOTE:
- Interior and exterior ferrous metal surfaces are epoxy-coated
 - Only 30" and 36" valves have a bottom cover plate (see pentagon ballon items)
 - Mount in orientation shown for buried service
 - Gearbox for buried service will not have position indicator
 - Body castings are tri-marked with "Clow," "Kennedy," and "M&H"

A (VALVE SIZE)	B	C	D	F	G	H	I	J	K	L	WEIGHT (LBS)	ROTOR GEAR	GEAR RATIO	TURNS TO OPEN (APPROX)	WATER WORKING PRESSURE PSI	HYDROSTATIC TEST PSI
18	29.25	1.0	Ø 24.84	12 x Ø 7/8 THRU	Ø 23-1/4	16.42	21.50	27.6	15.5	18.3	1262	IW6 AWWA-IP68	152:1	38	150 PSI	300 PSI
20	31.0	1.02	Ø 27.08	14 x Ø 7/8 THRU	Ø 25-1/2	17.09	22.25	28.6	15.5	17.4	1537	IW6 AWWA-IP68	228:1	57		
24	42.00	1.02	Ø 31.57	16 x Ø 7/8 THRU	Ø 30	21.06	26.37	35.4	21.6	21.8	3421	IW7 AWWA-IP68	384:1	96		
30	51.00	1.32	Ø 39.12	20 x Ø 1-1/8 THRU	Ø 36-7/8	22.19	30.69	37.2	27.2	22.5	6135	IW9 AWWA-IP68	696:1	174		
36	60.00	1.45	Ø 46.00	24 x Ø 1-1/8 THRU	Ø 43-3/4	25.81	34.75	42.3	27.2	27.7	8515	IW9 AWWA-IP68	928:1	232		

REV.	DESCRIPTION	DATE	APPROVED
1	RELEASED	11/13/15	ML
2	UPDATED FASTENER VIEW AND NOTES	2/19/2016	ML
3	ADDED ENCAPSULATION TO PLUG AND UPDATE TITLE BLOCK	4/5/2016	ML
4	UPDATED GEAR INFORMATION	5/11/2018	J CAPPER
5	316 SS STANDARD	2/19/2019	EPB
6	ADDED # OF TURNS TO OPEN AND CORRECTED GEARING INFORMATION. UPDATED # OF ADAPT. L, K, & L TO TABLE. REMOVED 14" AND 16" FROM DWG.	3/26/2019	CAW
7	ADDED TRI-MARKING NOTE	4/8/2019	J CAPPER

DRAWN	ML	DATE	12/17/2015		M&H VALVE Division of McWane, Inc. <small>605 West 23rd Street, Anniston, Alabama 36201</small>	
CHECKED	ML	DATE	11/13/2015			
APPROVED		TITLE:	8"-36" 100% PORT MJ Eccentric Plug Valve w/ ROTORK GEAR for Buried Service			
TO NET SCALE DRAWING			SIZE	DWG. NO.	REV	
MATERIAL: SEE TABLE			D	SUB910280T	7	
WEIGHT: SEE TABLE			SHEET 1 OF 1			