

OPEN

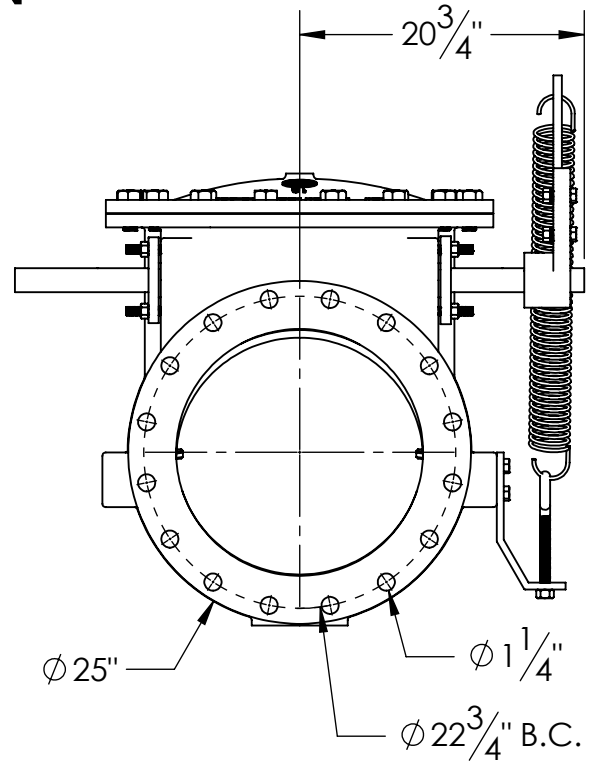

CLOSED

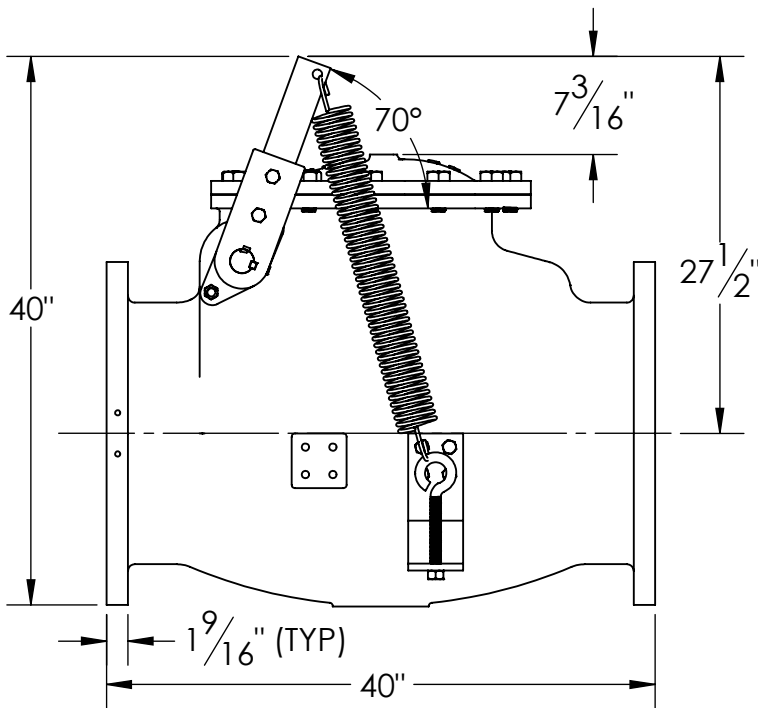
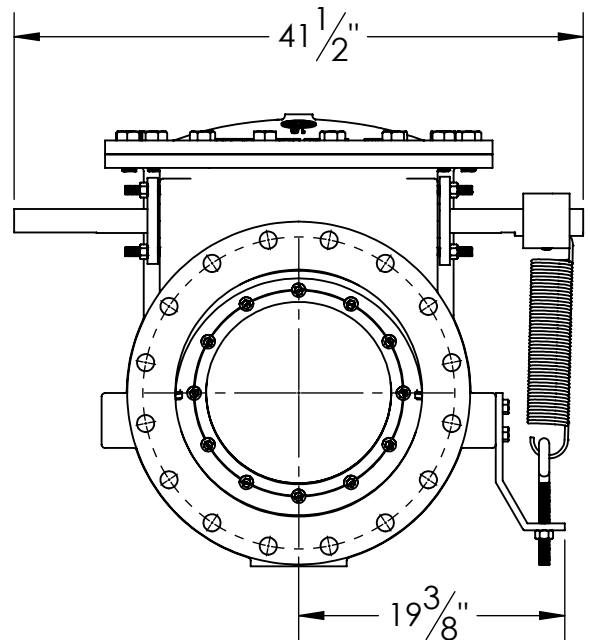
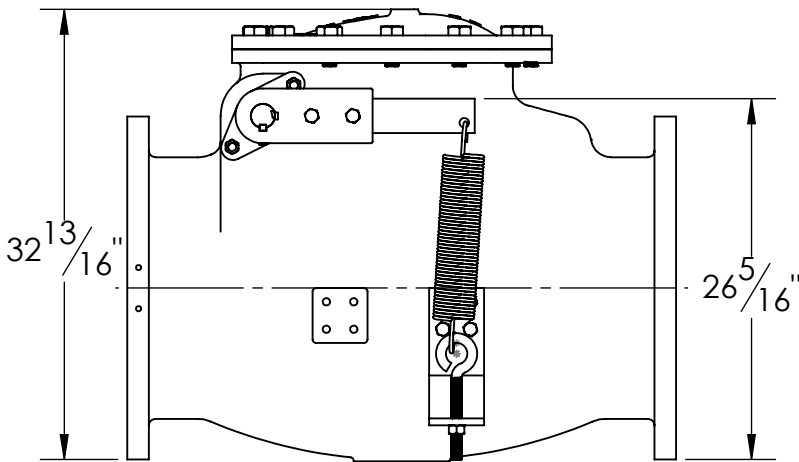

1. FLOW DIRECTION IS SPECIFIED ON VALVE.
2. VALVE WILL MEET OR EXCEED AWWA C508 REQUIREMENTS.
3. RATED AND TESTED FOR 150psi WORKING PRESSURE.
4. VALVES ARE SUITABLE FOR HORIZONTAL OR VERTICAL POSITION INSTALLATION.
5. REFERENCE AWWA C508 FOR FLANGES AND DRILLING.
6. (16) 1 1/8" BOLTS ON EACH FLANGE (NO THREADED HOLES)

THIS DWG. AND ALL INFORMATION IS OUR PROPERTY AND SHALL NOT BE USED, COPIED, OR REPRODUCED WITHOUT WRITTEN CONSENT. DESIGN AND INVENTION RIGHTS RESERVED.



M&H VALVE COMPANY

A DIVISION OF McWANE INC.
P.O. BOX 2088
ANNISTON, ALABAMA 36202

DWG. NO.
CD18-S1111-0010-N00
DRAWN: EMW
DATE: 02/11/2021

REV.
-

18" STANDARD CHECK VALVE - FLANGED ENDS - LEVER & SPRING DIMENSIONS

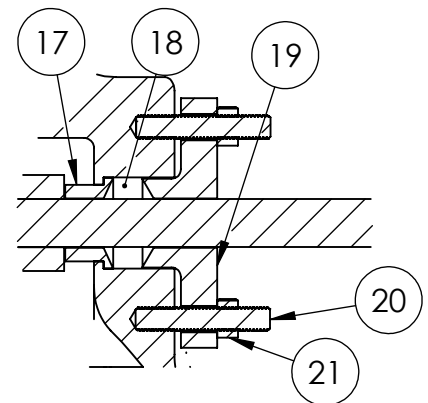
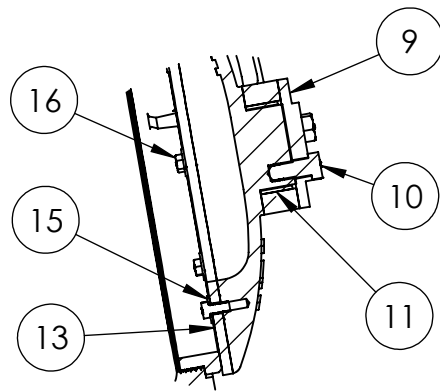
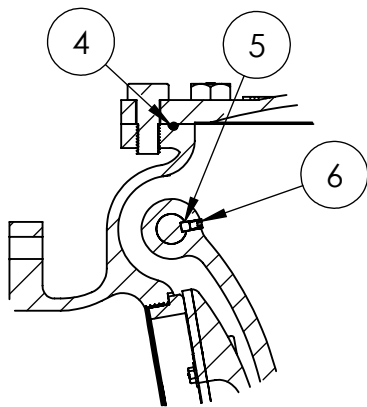
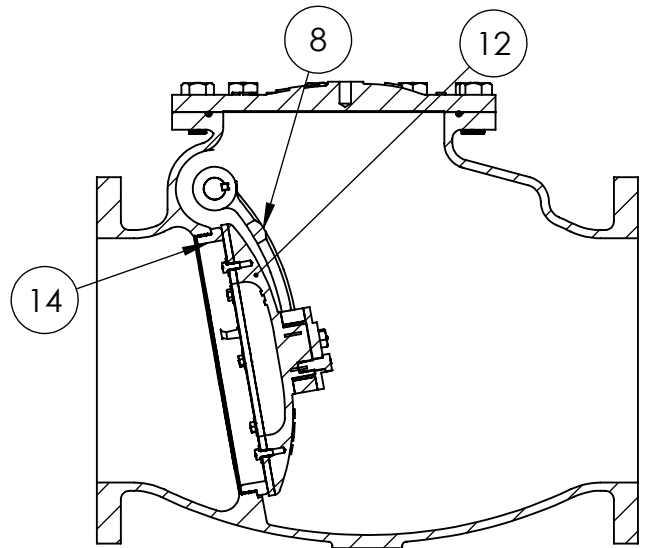
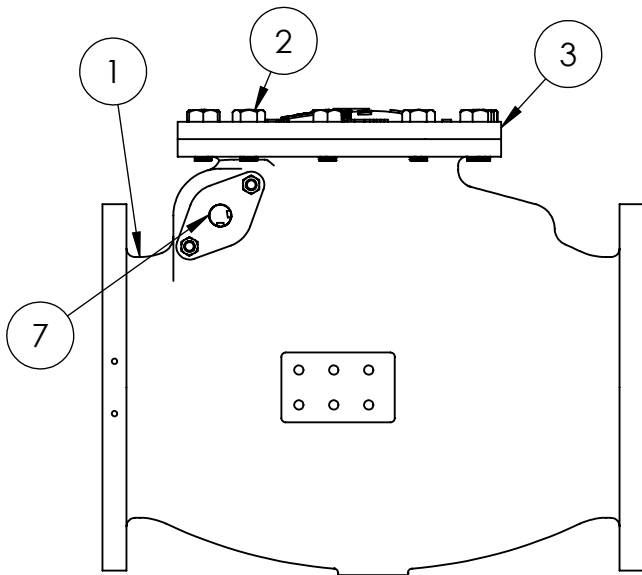

CLAPPER ARM DETAILS

CLAPPER DETAILS

STUFFING BOX DETAILS

| ITEM NO. | DESCRIPTION | MATERIAL |
|----------|--------------------------------|--|
| 1 | BODY - F.E. | DUCTILE IRON A536 65-45-12 OR 70-50-05 |
| 2 | COVER BOLTS | ASTM A-307 GR. B, OR A EZ PLATED |
| 3 | COVER | DUCTILE IRON A535 65-45-12 OR 70-50-05 |
| 4 | COVER O-RING | BUNA "N" DUROMETER 70 APPROVED |
| 5 | CLAPPER ARM KEY | 304 STAINLESS STEEL |
| 6 | SET SCREW | ALLOY STEEL (RC 45-63) |
| 7 | HINGE PIN | STAINLESS STEEL ASTM A-276 TYPE 303 |
| 8 | CLAPPER ARM | DUCTILE IRON A536 65-45-12 OR 70-50-05 |
| 9 | CLAPPER CAP PLATE | 304 STAINLESS STEEL |
| 10 | HEX BOLT CAP PLATE | 18-8 STAINLESS STEEL |
| 11 | CLAPPER ARM BUSHING | BRASS C26000 |
| 12 | CLAPPER | DUCTILE IRON A536 65-45-12 OR 70-50-05 |
| 13 | ENCAPSULATED RUBBER CLAMP RING | BUNA "N" DUROMETER 70 APPROVED |
| 14 | BODY RING | BRONZE ALLOY C89836 |
| 15 | WASHER, FLAT | 18-8 STAINLESS STEEL |
| 16 | HEX BOLT CLAMP RING | 18-8 STAINLESS STEEL |
| 17 | STUFFING BOX BUSHING | BRONZE ALLOY C87850 |
| 18 | PACKING | MULTI-LOK BRAID STYLE ML2254 PTFE |
| 19 | STUFFING BOX GLAND | DUCTILE IRON A536 65-45-12 OR 70-50-05 |
| 20 | STUD | STEEL ASTM A307, EZ PLATED |
| 21 | HEX NUT | 18-8 STAINLESS STEEL |

THIS DWG. AND ALL INFORMATION IS OUR PROPERTY AND SHALL NOT BE USED, COPIED, OR REPRODUCED WITHOUT WRITTEN CONSENT. DESIGN AND INVENTION RIGHTS RESERVED.



M&H VALVE COMPANY
 A DIVISION OF McWANE INC.
 P.O. BOX 2088
 ANNISTON, ALABAMA 36202

DWG. NO.
 CBAA-S1111-0000-N00
 DRAWN: EMW
 DATE: 02/04/2021
 REV.
 -

14" THRU 36" AWWA C508
 STANDARD CHECK VALVES
 FLANGED ENDS - NSF61/372
 MATERIAL LIST

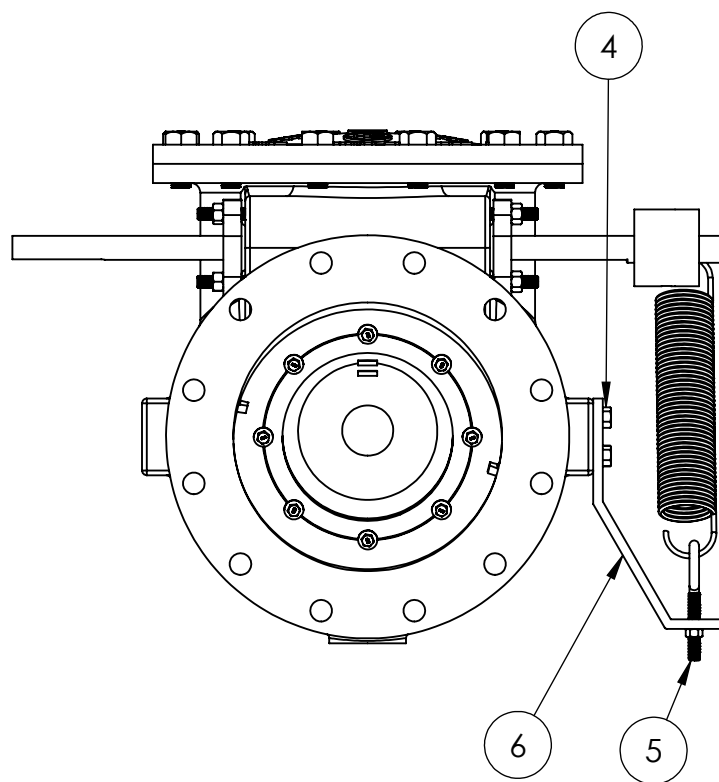
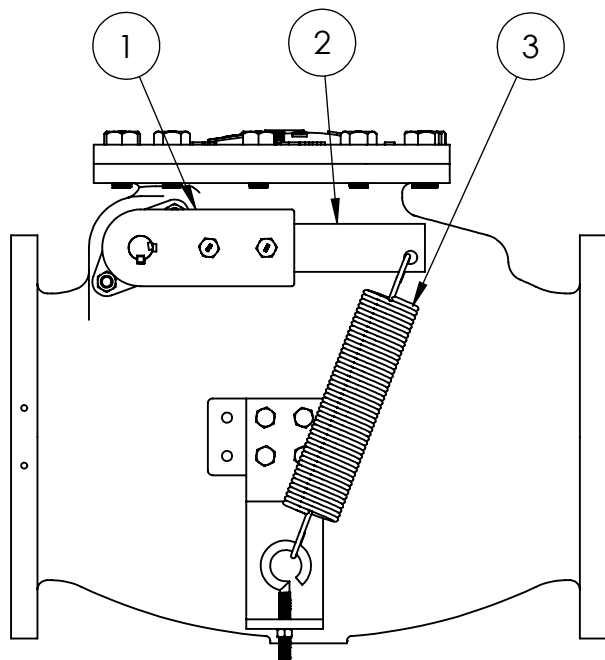

LEVER & SPRING CHECK VALVE ASSEMBLY

| ITEM NO. | DESCRIPTION | MATERIAL |
|----------|--------------------------|--|
| 1 | SPRING ARM LEVER | DUCTILE IRON A536 65-45-12 OR 70-50-05 |
| 2 | SPRING ARM BAR | CR STEEL C-1018/1020 |
| 3 | SPRING | STEEL |
| 4 | SPRING BRACKET CAP SCREW | STEEL A-307 GRADE B |
| 5 | SPRING EYEBOLT | STEEL A-307 GRADE B |
| 6 | SPRING BRACKET | STEEL |

THIS DWG. AND ALL INFORMATION IS OUR PROPERTY AND SHALL NOT BE USED, COPIED, OR REPRODUCED WITHOUT WRITTEN CONSENT. DESIGN AND INVENTION RIGHTS RESERVED.



M&H VALVE COMPANY
 A DIVISION OF McWANE INC.
 P.O. BOX 2088
 ANNISTON, ALABAMA 36202

DWG. NO.
 CBBB-S1111-0010-N00
 DRAWN: EMW
 DATE: 02/05/2021

REV.
 -

14" THRU 24" LEVER AND SPRING
 AWWA C508 CHECK VALVES
 NSF61/372 - MATERIAL LIST

OPTIONAL BY SPECIAL REQUEST

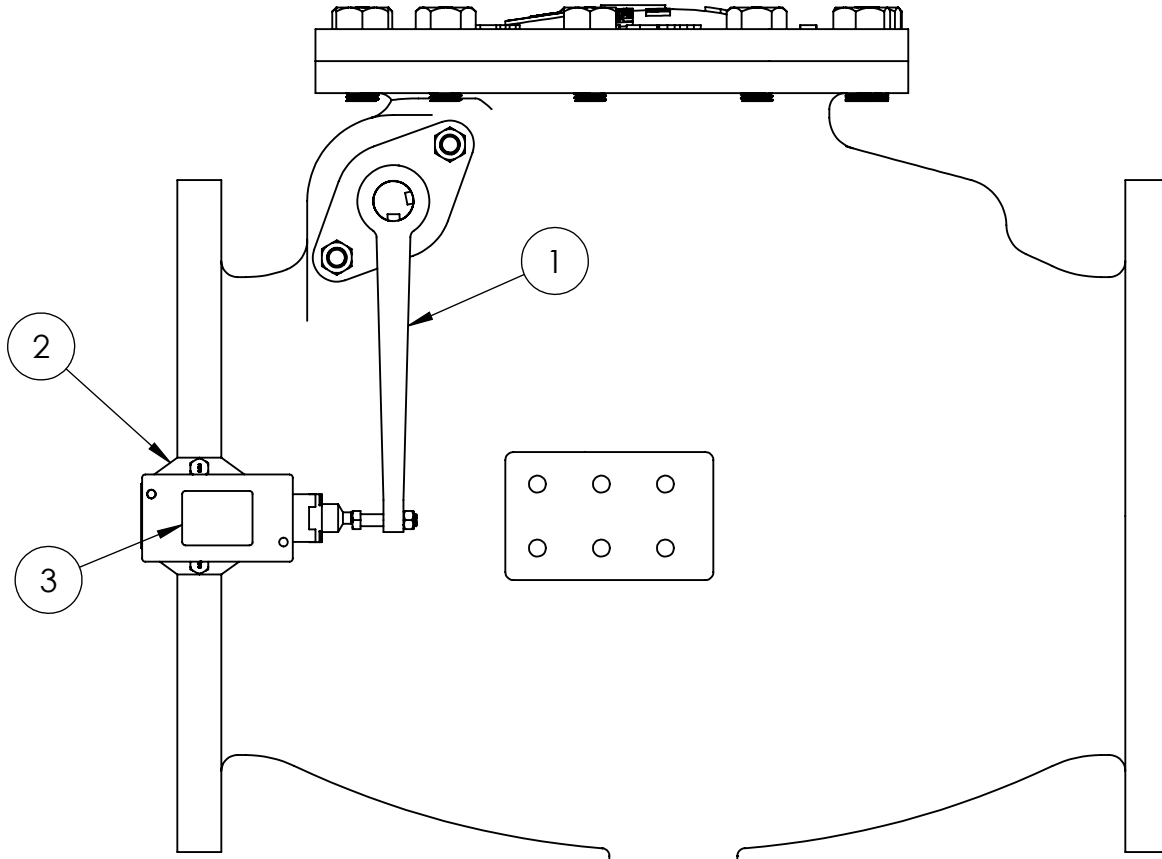

LIMIT SWITCH CHECK VALVE ASSEMBLY

| ITEM NO. | DESCRIPTION | MATERIAL |
|----------|------------------|-----------------|
| 1 | TRIPPER ARM | STEEL |
| 2 | MOUNTING BRACKET | STEEL |
| 3 | LIMIT SWITCH | SD-D-TYPE-CR53E |

THIS DWG. AND ALL INFORMATION IS OUR PROPERTY AND SHALL NOT BE USED, COPIED, OR REPRODUCED WITHOUT WRITTEN CONSENT. DESIGN AND INVENTION RIGHTS RESERVED.



M&H VALVE COMPANY

A DIVISION OF McWANE INC.
P.O. BOX 2088
ANNISTON, ALABAMA 36202

DWG. NO.
CBAA-S1111-0000-Y00

DRAWN: EMW
DATE: 02/22/2021

REV.
-

14" THRU 36" LIMIT SWITCH OPTION -
AWWA C508 CHECK VALVES
NSF61/372 - MATERIAL LIST